

Personalize any room with this elegant and decorative lampshade

With a little creativity, even an everyday object can become something special. Flower patterns, beads, ribbons, and other favorite items can transform a plain lampshade into a thing of beauty. Your handiwork can turn a room that's all your own.

With a little creativity, even an everyday object can become something special. Flower patterns, beads, ribbons, and other favorite items can transform a plain lampshade into a thing of beauty. Your handiwork can turn a room that's all your own.



Lampshade

Material

Outer dimensions: 13" x 13"

Fabric – 5 kinds

Flowers – AR-A010 L: 5.60" x 5.83", M: 3.73" x 3.94",
S: 1.18" x 1.20"

AR-A020 L: 4.72" x 4.67", M: 2.76" x 2.72",
S: 1.22" x 1.19"

Beads, rhinestones, cloth-covered button

Table lamp, needle, thread, glue, thick adhesive core

● Optional Accessory:

Iron-On Fabric Appliqué Contact Sheet



Tip Use the Iron-On Appliqué Contact Sheet for double duty! Use it to stabilize your material for a perfect precise cut and then apply your design seamlessly to your lampshade along with an adhesive core for strength with the simple press of an iron.

- 1** Attach the Iron-On Fabric Appliqué Contact Sheet to the back of the fabric to cut.

- 2** Cut the built-in pattern shapes for the flowers as shown in the photo.

Built-in Patterns: AR-A010 – L x 2, M x 2, S x 4

AR-A020 (piece A) – L x 2, M x 4, S x 4

- 3** Stack the cut flower pieces from step 2 and string them together using thread and a cloth-covered button.

- 4** Cut the other built-in pattern shapes.

Built-in Patterns: AR-J014

AR-J015

- 5** Use fabric glue to attach all pieces to the shade, giving attention to achieving an attractive overall balance.

- 6** Sew on beads and other decorative elements.

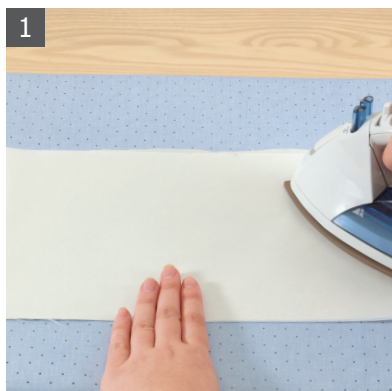

Front

Back