

Bring smiles with this cheerful framed patchwork quilt

This framed patchwork square makes a great gift. Have fun choosing combinations of shapes and layouts to create a piece that adds a lasting accent to any room, for a heartfelt gift that the recipient will treasure.



Finished size (patchwork) 7.87" x 7.87"

## Material

- A: Patchwork fabric (light blue): 11.81" x 11.81"
- B: Patchwork fabric (light orange): 11.81" x 11.81"
- C: Patchwork fabric (pink): 11.81" x 11.81"
- D: Patchwork fabric (ivory): 11.81" x 11.81"
- E: Appliqué fabric (green): 7.87" x 7.87"
- F: Appliqué fabric (light green): 7.87" x 7.87"
- Sewing thread for appliqué stitching
- Appliqué piece template: Plastic sheet

● Optional Accessories:

- High Tack Adhesive Fabric Support Sheet
- Erasable Pen Set
- Pen Holder
- Quilt Pattern Collection (USB)

**brother**<sup>®</sup>  
at your side

Quilt Pattern Collection  
Designed by Suzuko Koseki





## Framed Patchwork Square

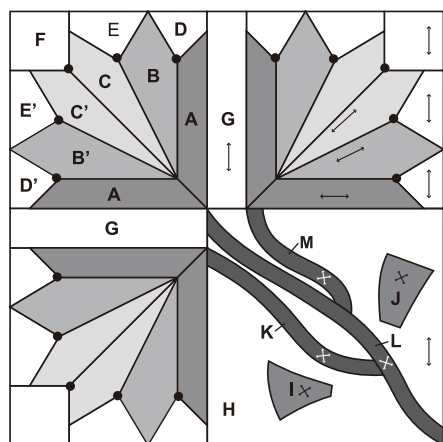

(SK\_A035)

### Preparations

Attach the plastic sheet to the Standard Mat.

- 1 Insert the USB flash drive into the machine and select the pattern (SK\_A035). Select the appliqué pieces (I through M).

- 2 Use Auto Layout to arrange the pieces.

Function: Editing Functions (Auto Layout Functions)

- 3 Cut the template paper for the appliqué.

- 4 Put the Erasable Pen in the Pen Holder and mount the Pen Holder on the machine.

- 5 Attach the High Tack Adhesive Fabric Support Sheet to the Standard Mat. Orient fabric piece A so that its warp threads lie vertically.

- 6 Draw the outline for piece A.

Function: Editing Functions (Drawing Functions)

- 7 Replace the Pen Holder with the Standard Cut Blade Holder, then carry out cutting for the piece. The piece is cut with seam allowances.

- 8 Use the same procedure to draw and cut all the pieces.

- 9 Refer to the Basics Quilting Guide, and follow the instructions for piecing and appliqué to make the block.

- 10 Place the block in the frame.

## High Tack Adhesive Fabric Support Sheet

This is used when cutting pieces of patchwork or appliqué fabric with seam allowances.

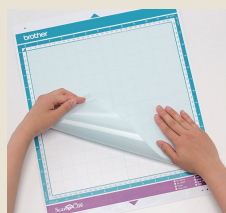

- 1 Attach the sheet to the Standard Mat and peel off the backing paper.

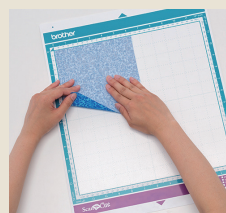

- 2 With the back of the fabric facing up, attach the fabric to the mat.

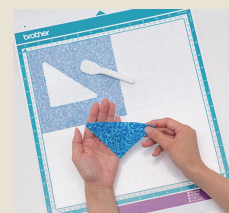

- 3 Cut the fabric, then peel off the cut shape from the mat.

