



BE-101,916,901,1216,1201 Quick Ref.

For Technical Assistance Please Call Toll Free 1-877-4BROTHER

LOADING A DESIGN FROM A FLOPPY DISK

Insert floppy disk into the disk drive

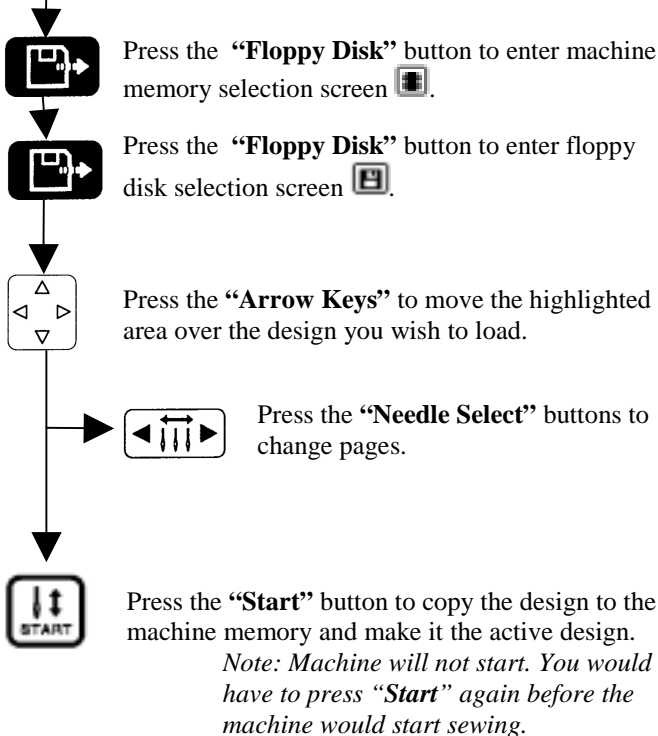

POSITIONING AND SEWING THE DESIGN

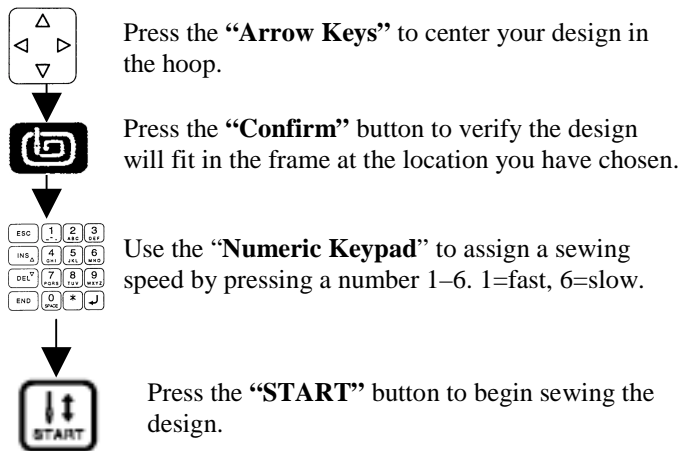

ENTER A DESIGN FROM THE MACHINE MEMORY

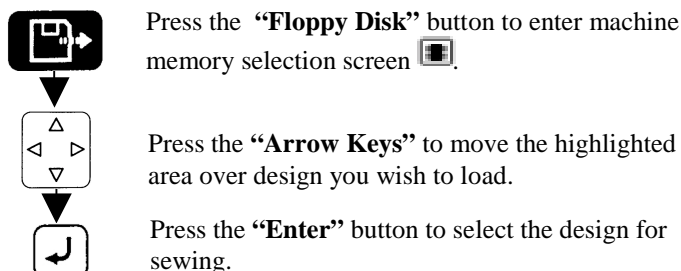

Set the color sequence for the design.

Position and Sew the design

SETTING THE COLOR SEQUENCE

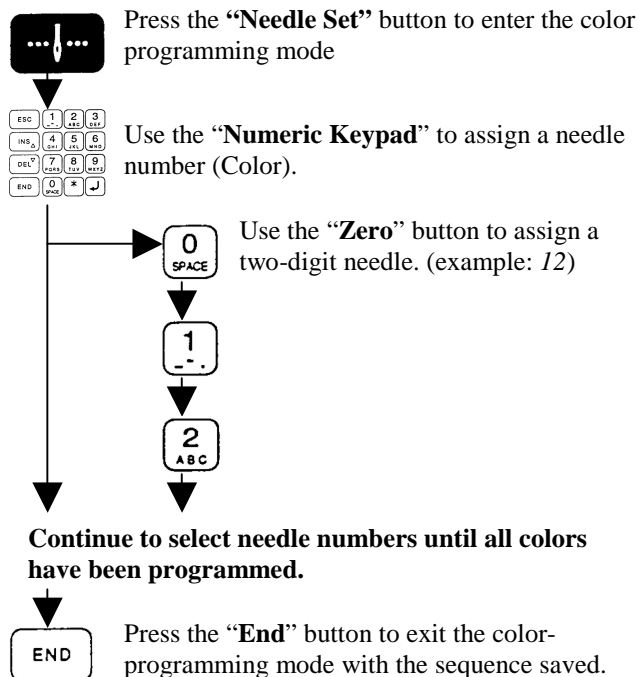

ROTATE A DESIGN

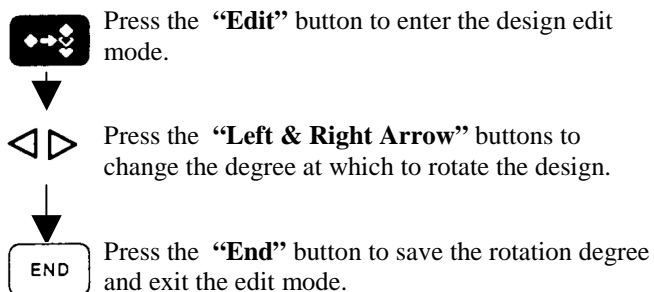

LOADING A DESIGN FROM COMPUTER

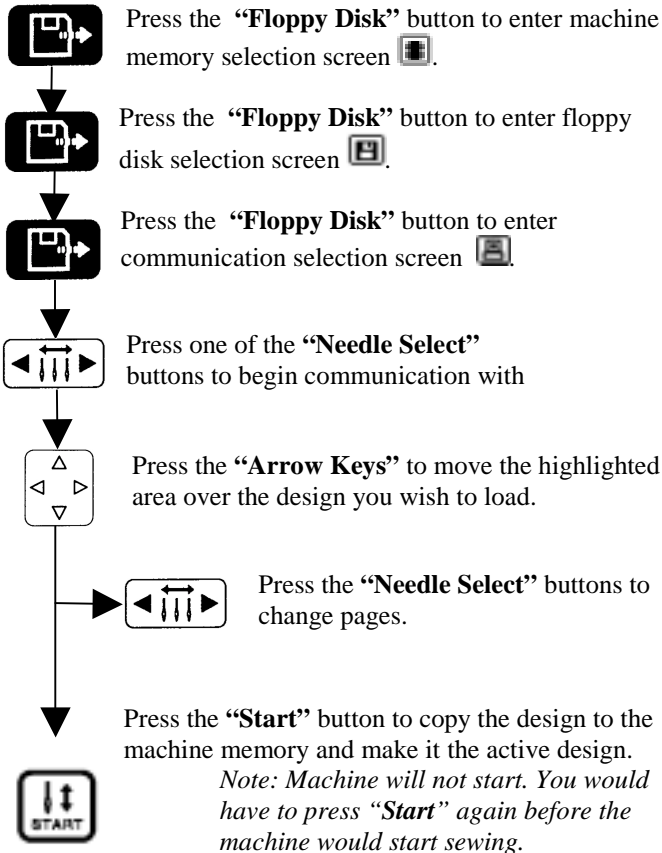

ERASING A STORED DESIGN FROM MEMORY

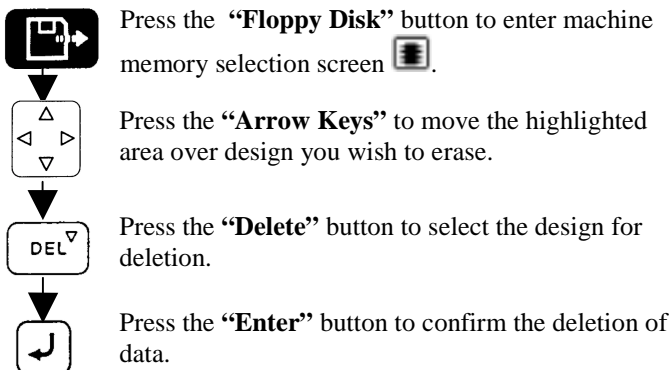

DELETE ALL DESIGNS STORED

Turn the power of the machine to the OFF position.

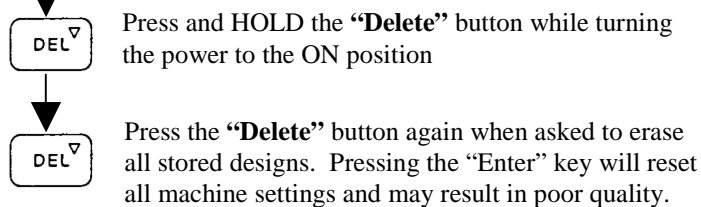

“FLOATING” THROUGH A DESIGN

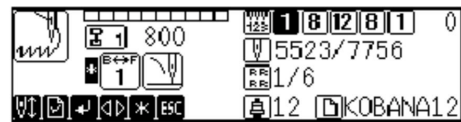

From the **“Stand-By Screen”** (Above).

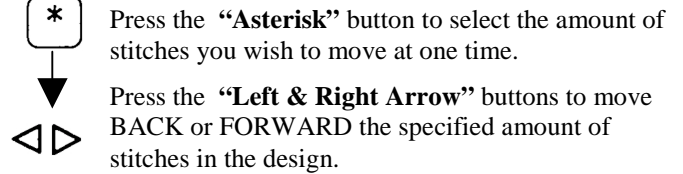

“FLOATING” TO A SPECIFIC STITCH NUMBER

From the **“Stand-By Screen”** (Above).

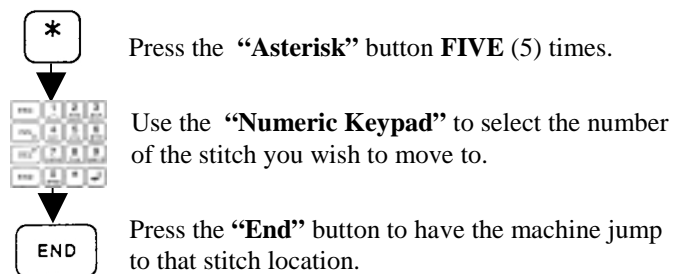

MOVING THE NEEDLE CASE

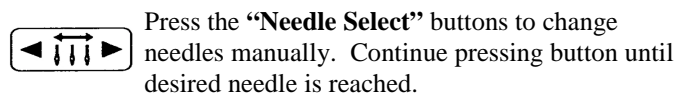

MANUALLY TRIMMING THE THREAD



CANCELLING SEWING



From the **“Stand-By Screen”** (Above) and the machine stopped.

