

brother®

# Quick Reference Guide

---

# Guía de Referencia Rápida

---

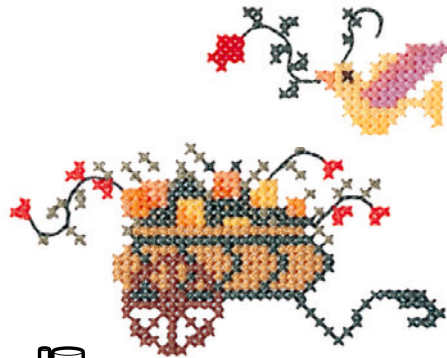
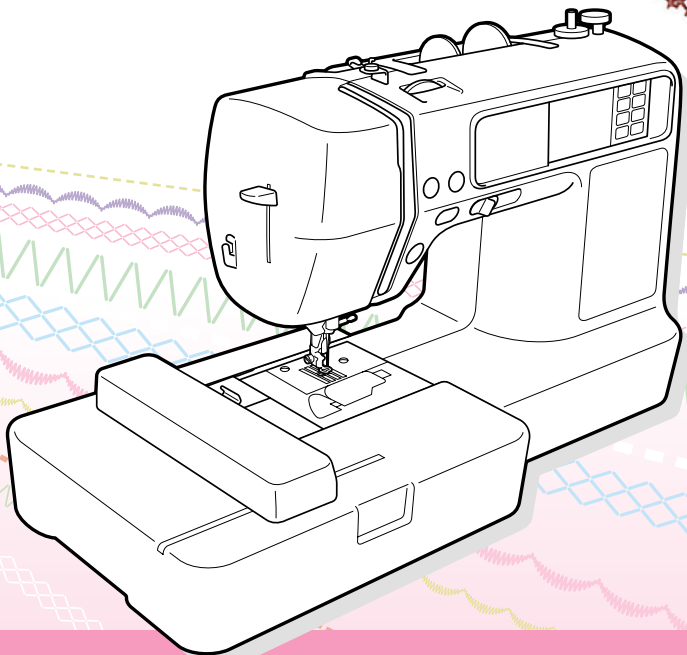
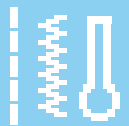
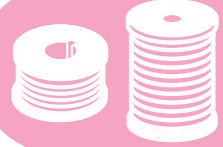

**Refer to the operation manual for detailed instruction.**

Also, there are differences in the keys and screens depending on the display language.

In this guide, English screens are used for basic explanations.

**Consulte el manual de instrucciones para ver más detalles.**

Además, dependiendo del idioma visualizado algunos botones y pantallas podrán ser diferentes.

En esta guía, para las explicaciones básicas se emplean pantallas en inglés.

## Machine Features Características de la máquina

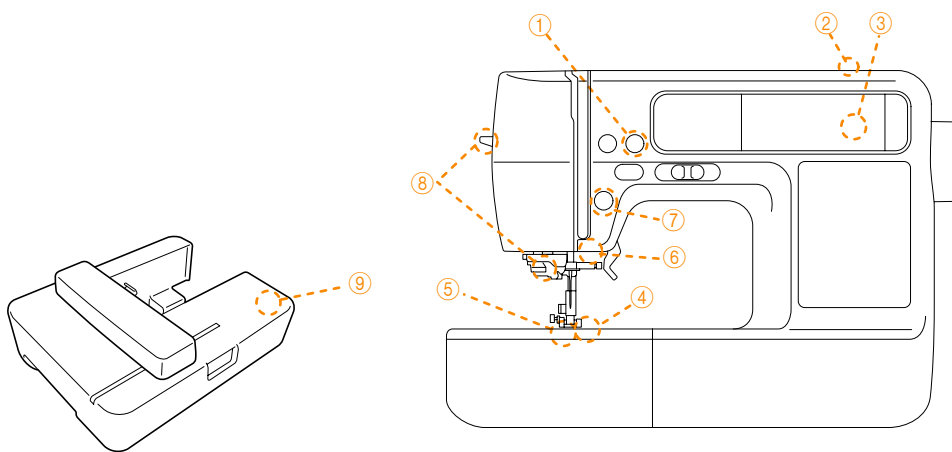

- ① **Automatic thread cutting:** The thread can be cut automatically after sewing.
  - ② **Fast bobbin winding system:** With the fast and simple bobbin winder, you can wind bobbins with one press of a button.
  - ③ **Built-in stitches:** You can select from the built-in utility stitches available.
  - ④ **Seven-point feed dogs:** Ensure smooth, even feeding of multiple fabric layers and a variety of fabric weights.
  - ⑤ **Quick-set bobbin:** You can start sewing without pulling up the bobbin thread.
  - ⑥ **Bright light:** The convenient LED lamp makes it easy to work on dark fabrics.
  - ⑦ **Lighting Start/Stop button:** When the green light is on, the machine is ready to sew. A red or orange light indicates an error or that the machine is warming up.
  - ⑧ **Easy-to-use needle threader:** You can thread the needle easily by one press of a lever.
  - ⑨ **Embroidery:** You can embroider built-in embroidery patterns, alphanumeric characters, framed decorations, and designs from optional embroidery cards.
- 
- ① **Corte automático del hilo:** El hilo se puede cortar automáticamente tras finalizar la costura.
  - ② **Sistema de devanado rápido de la bobina:** Con la rápida y simple devanadora, puede devanar bobinas con tan solo pulsar un botón.
  - ③ **Puntadas de costura incorporadas:** Puede seleccionar entre las puntadas incorporadas disponibles.
  - ④ **Dientes de arrastre de siete puntos:** Aseguran una alimentación suave y uniforme de varias capas de tela y de gran variedad de telas de peso variado.
  - ⑤ **Bobina de colocación rápida:** Puede empezar a coser sin tener que tirar del hilo de la bobina.
  - ⑥ **Iluminación brillante:** La lámpara LED facilita el trabajo con telas oscuras.
  - ⑦ **Iluminación del botón iniciar/parar:** Cuando la luz verde está encendida, la máquina está lista para comenzar a coser. Una luz roja o anaranjada indica que hay un error o que la máquina está en proceso de calentamiento.
  - ⑧ **Enhebrador de aguja de uso fácil:** Puede enhebrar la aguja fácilmente con tan sólo presionar una palanca.
  - ⑨ **Bordado:** Puede bordar patrones incorporados, caracteres alfanumérico, motivos decorativos encuadrados y patrones incluidos en tarjetas de memoria de bordado opcionales.

---

## Contents Contenido

	<b>Bobbin Winding and Setting</b> <b>Bobinado y ajuste</b>	<b>2</b>
	<b>Upper Threading</b> <b>Hilo superior</b>	<b>4</b>
	<b>Selecting Stitch Patterns</b> <b>Selección de tipos de puntada</b>	<b>6</b>
	<b>Summary of Stitch Patterns</b> <b>Resumen de tipos de puntada</b>	<b>7</b>
	<b>Preparing to Embroider</b> <b>Preparativos para bordar</b>	<b>8</b>
	<b>Selecting Embroidery Patterns</b> <b>Selección de diseños de bordados</b>	<b>10</b>
	<b>Alphanumeric Character Patterns</b> <b>Patrón de caracteres alfanumérico</b>	<b>13</b>
	<b>Frame Patterns</b> <b>Costuras de encuadre</b>	<b>15</b>
	<b>Embroidery Pattern Color Change Table</b> <b>Tabla de cambio de color para patrones de bordado</b>	<b>16</b>
	<b>Color Thread Conversion Chart</b> <b>Tabla de conversión de hilos de color</b>	<b>20</b>

# Bobbin Winding and Setting

## Bobinado y ajuste



Follow the numbered steps below in order. Refer to the operation manual for detailed instruction.

Realice los siguientes pasos numerados en el orden indicado. Para obtener instrucciones detalladas, consulte el manual de instrucciones.

Use only the enclosed bobbin or bobbins of the same type.

Utilice sólo la bobina incluida o bobinas del mismo tipo.

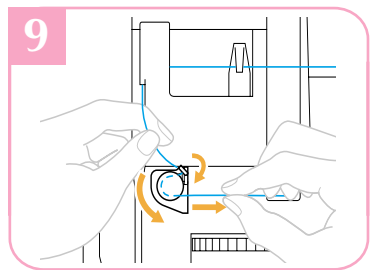
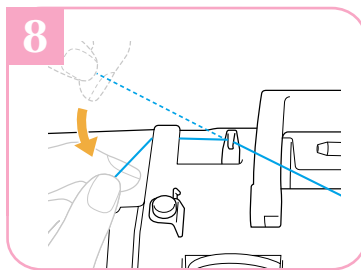
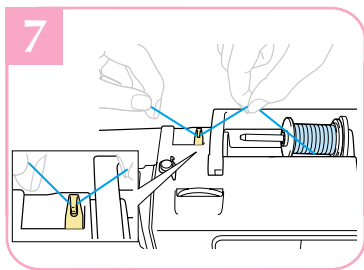
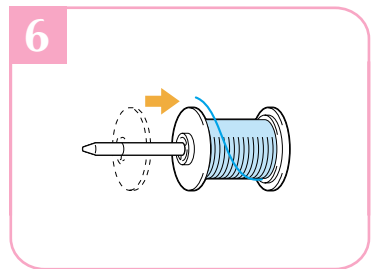
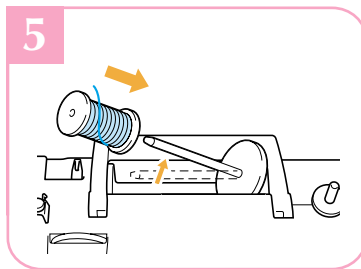
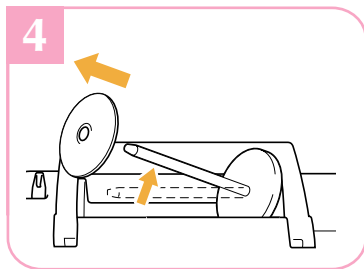
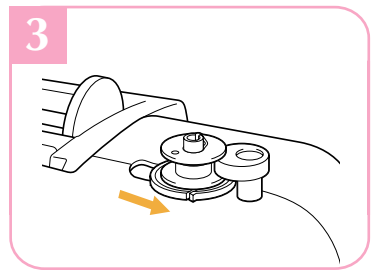
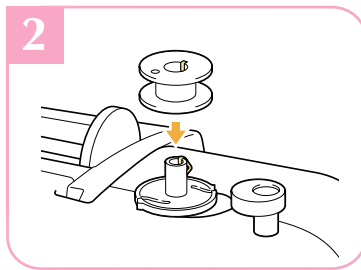
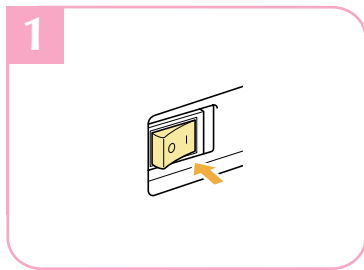
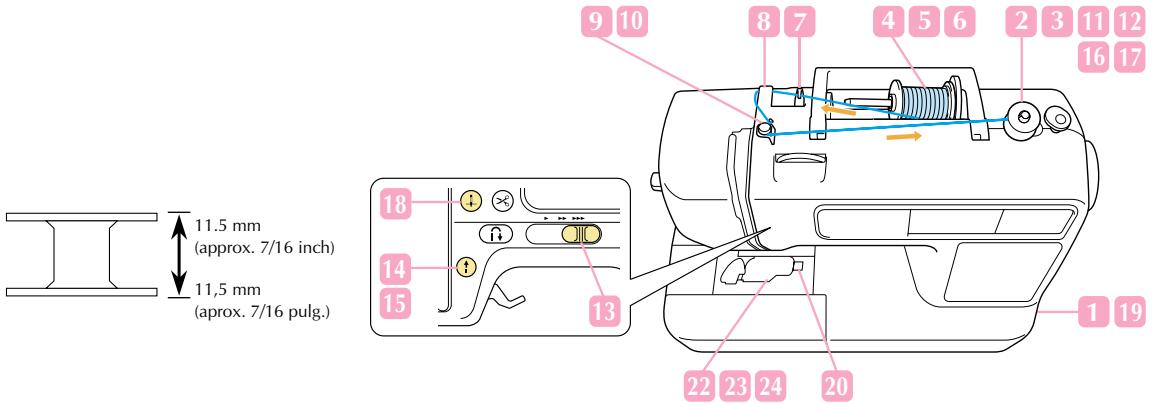

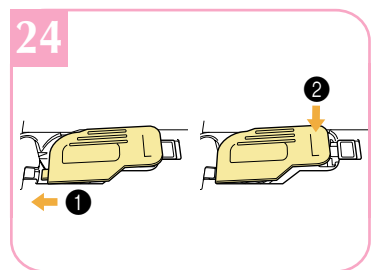
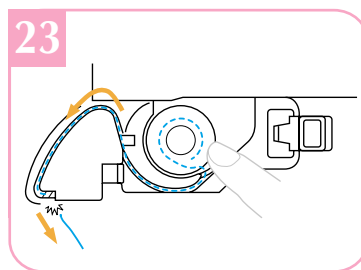
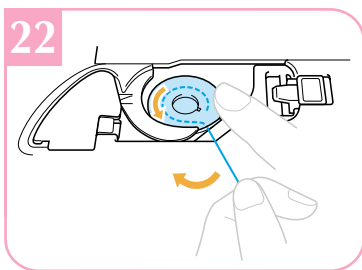
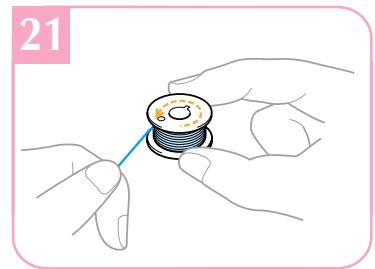
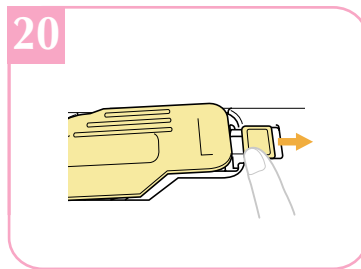
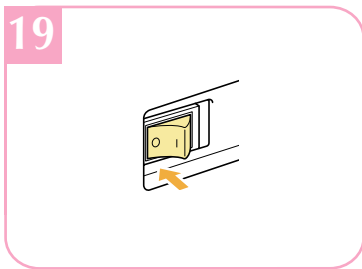
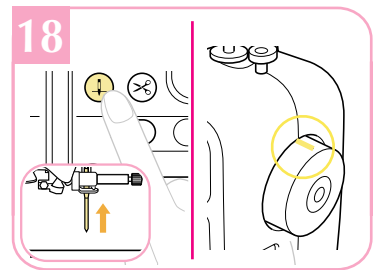
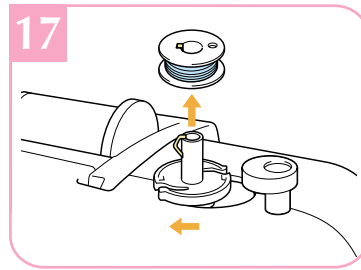
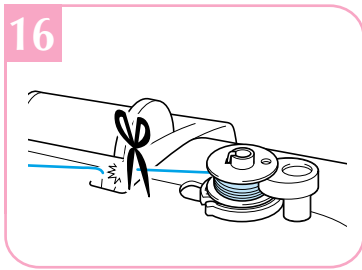
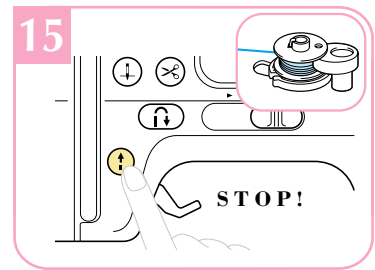
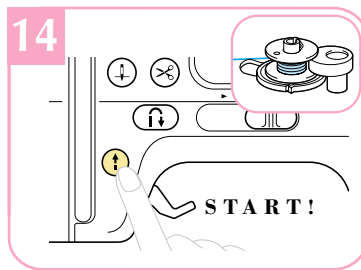
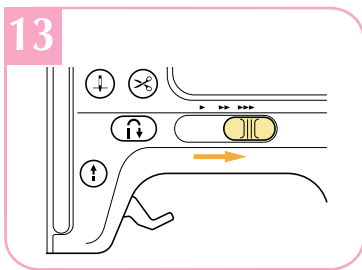
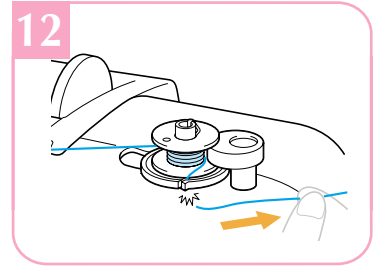
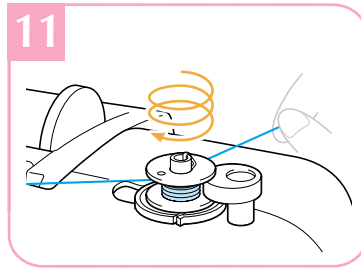
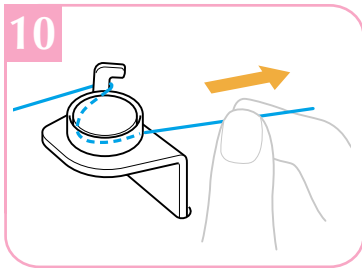

# Upper Threading Hilo superior

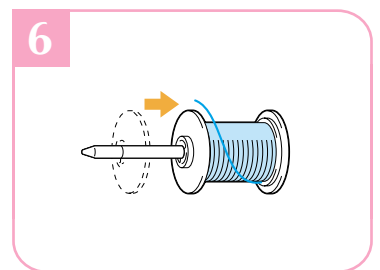
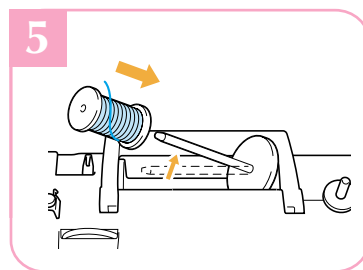
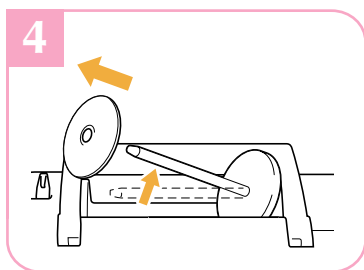
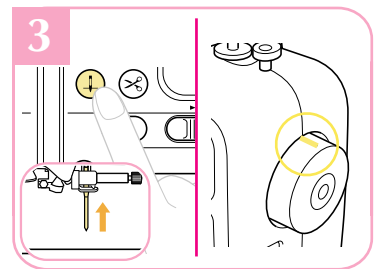
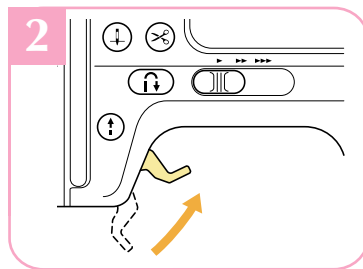
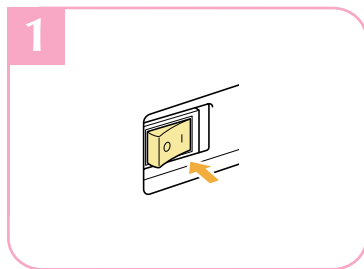
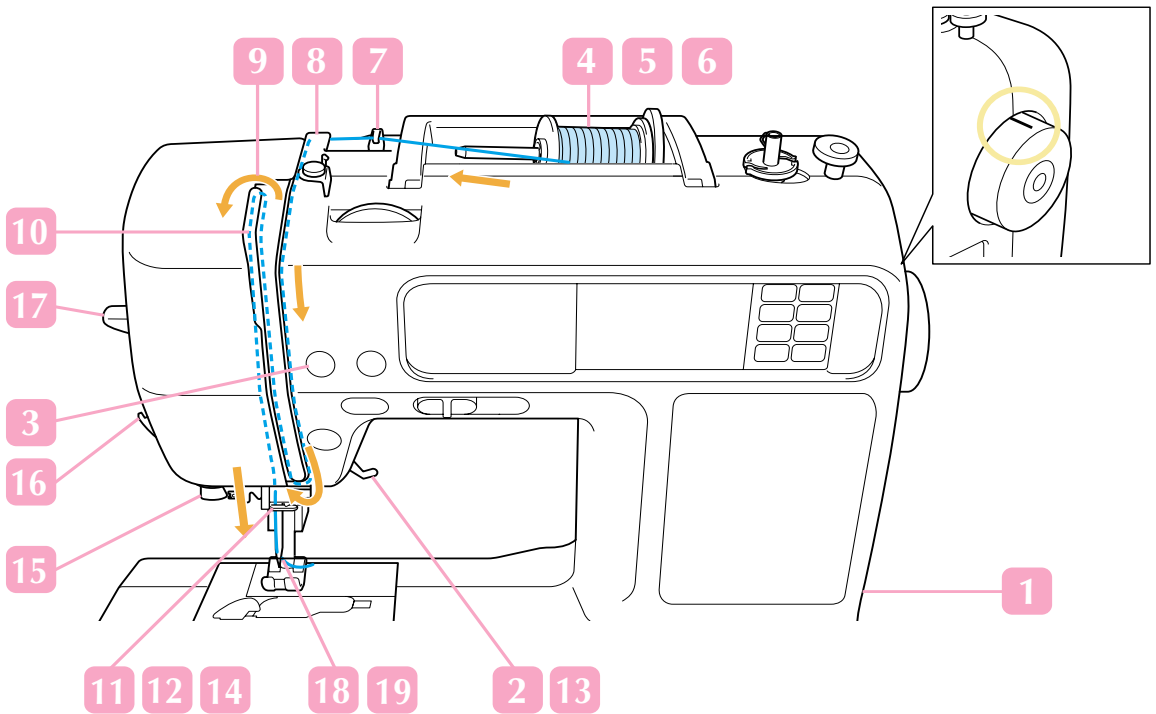
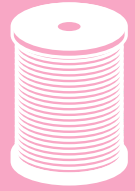

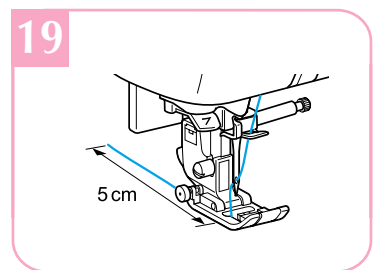
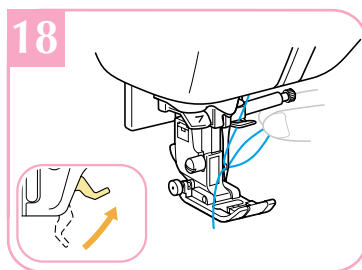
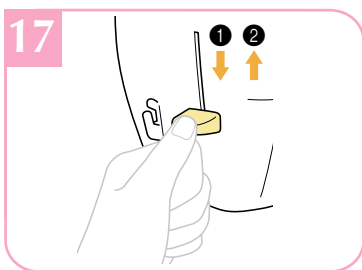
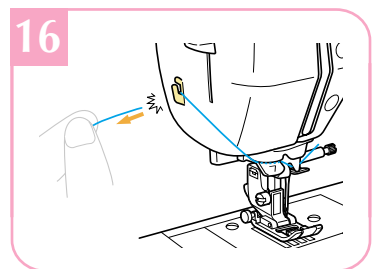
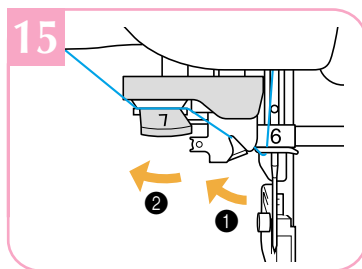
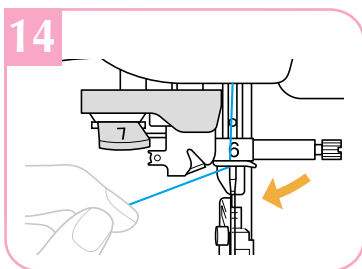
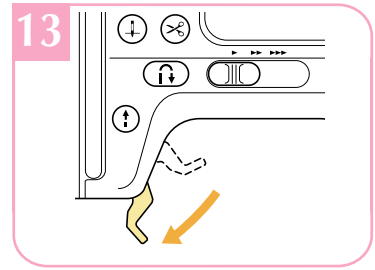
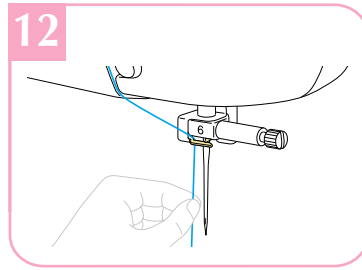
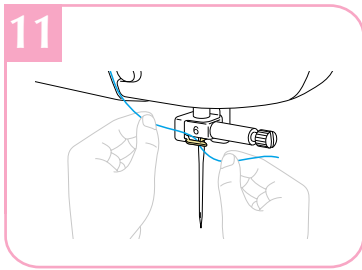
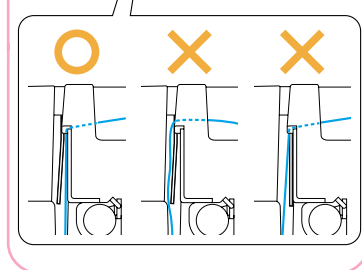
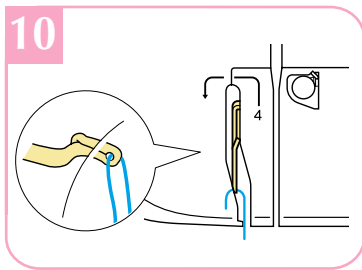
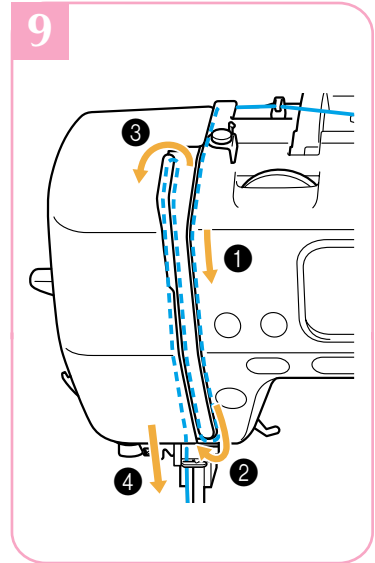
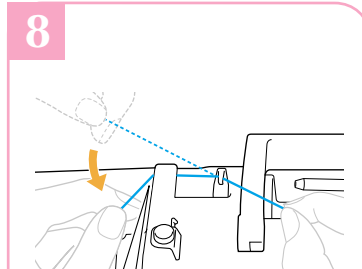
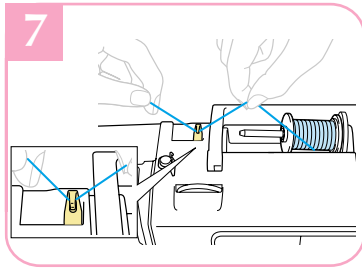

# Selecting Stitch Patterns Selección de tipos de puntada

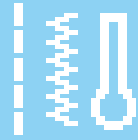

- ◆ Utility Stitches
- ◆ Puntadas utiles

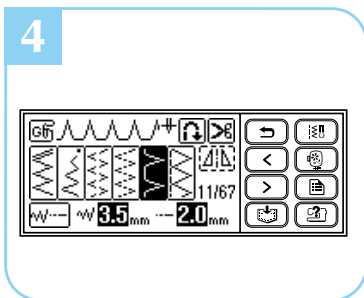
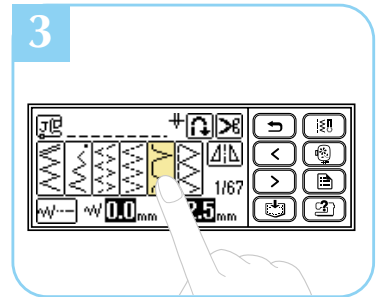
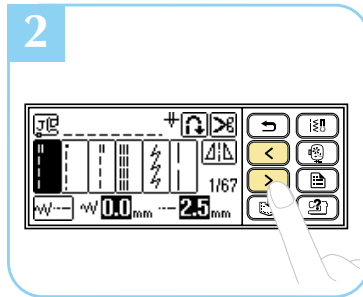
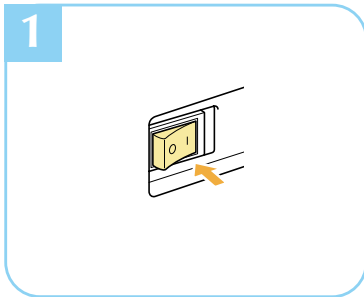

## LCD Flow Chart Diagrama de flujo del LCD

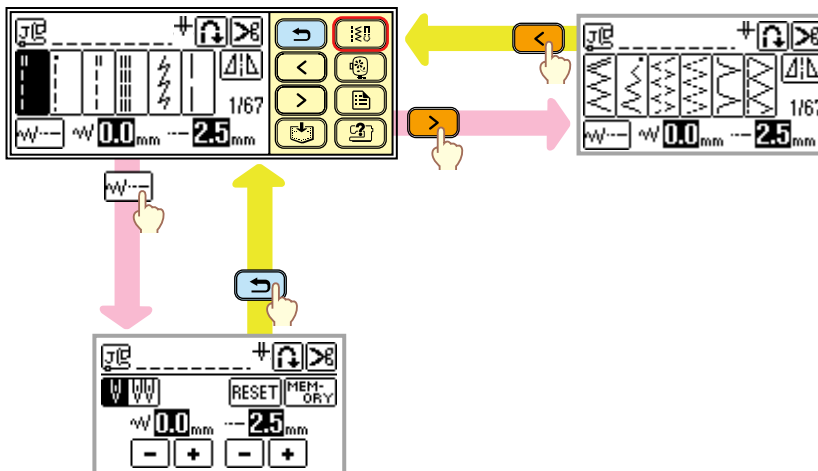



# Summary of Stitch Patterns

## Resumen de tipos de puntada

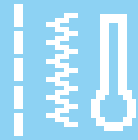

- ◆ Utility Stitches
- ◆ Puntadas utiles

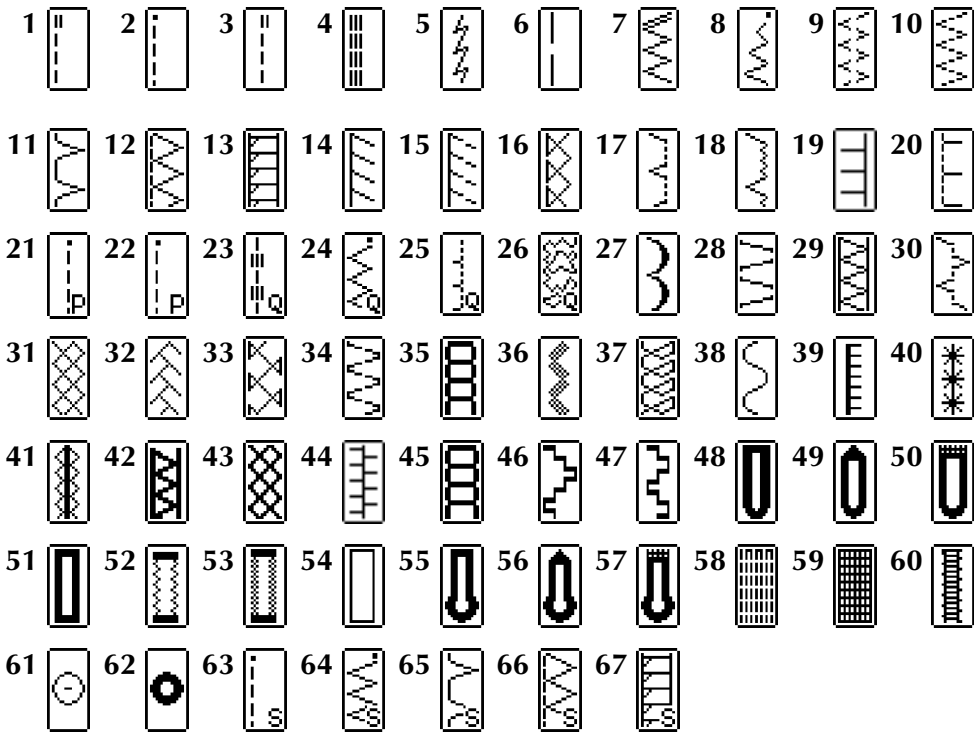

# Preparing to Embroider Preparativos para bordar

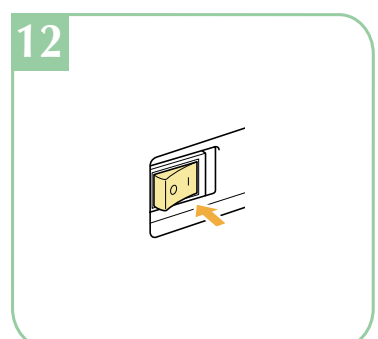
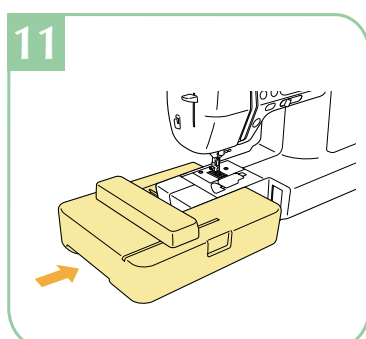
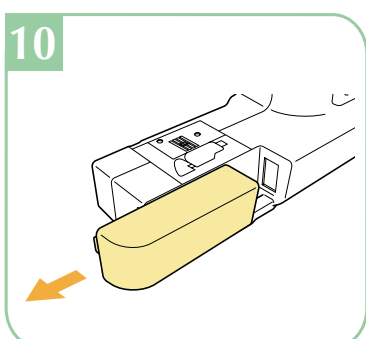
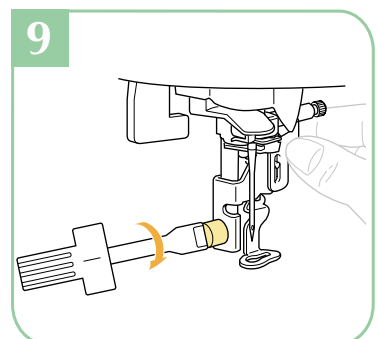
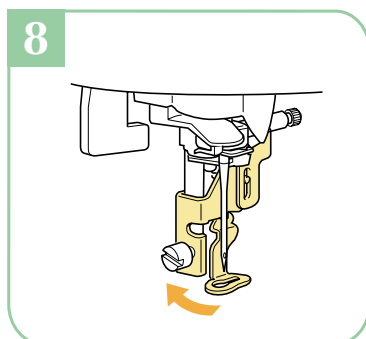
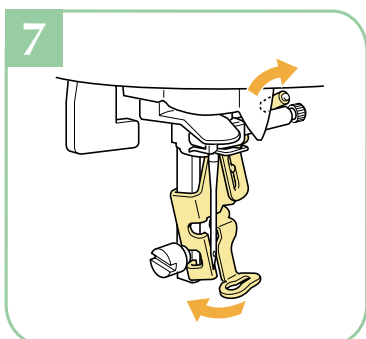
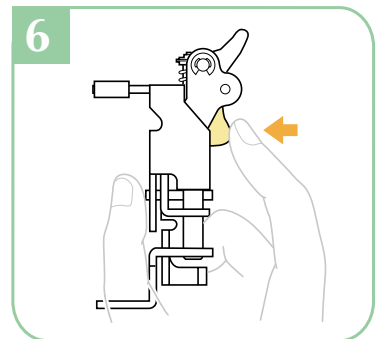
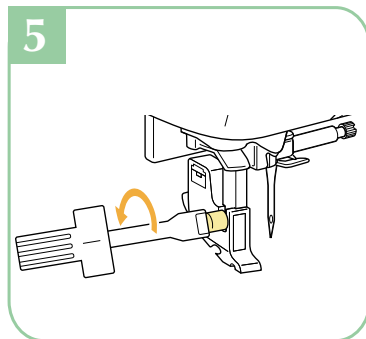
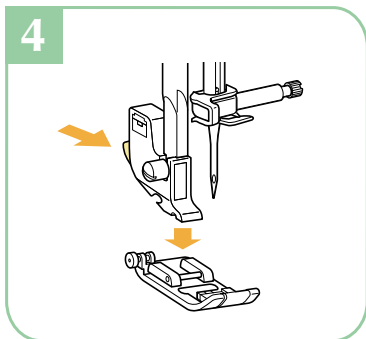
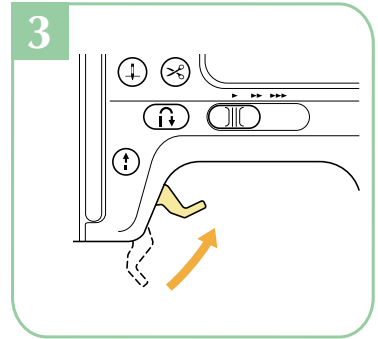
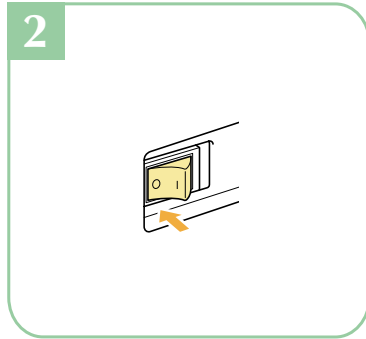
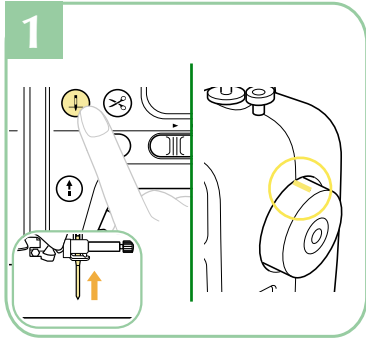

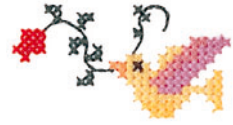

13

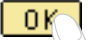
 The carriage of the embroidery unit will move.  

14

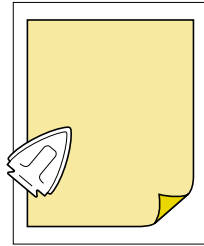

15

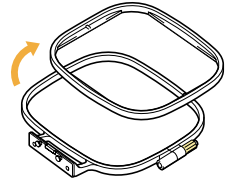

16

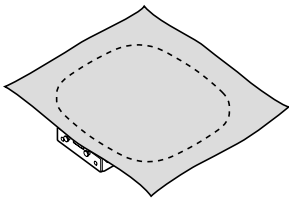

17

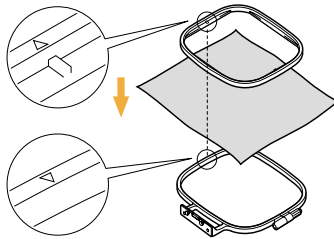

18

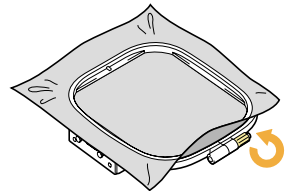

19

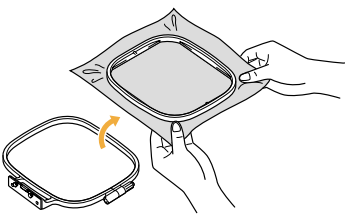

20

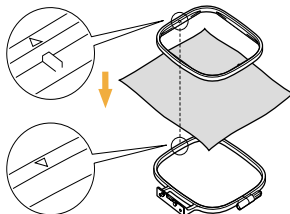

21

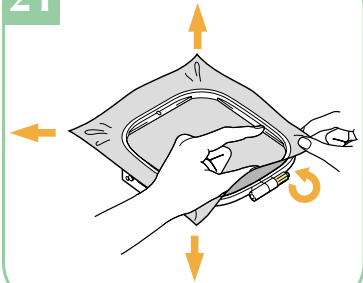

22

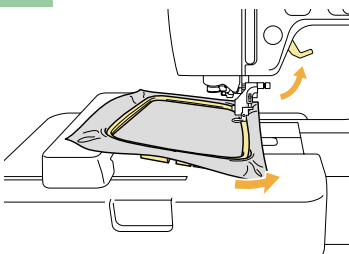

23

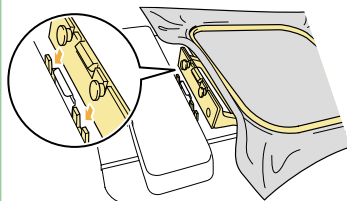

# Selecting Embroidery Patterns

## Selección de diseños de bordados

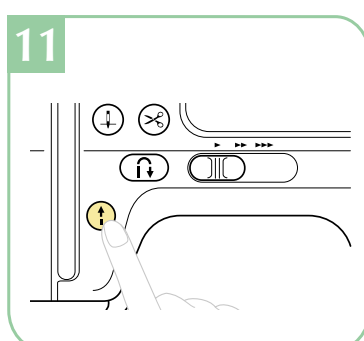
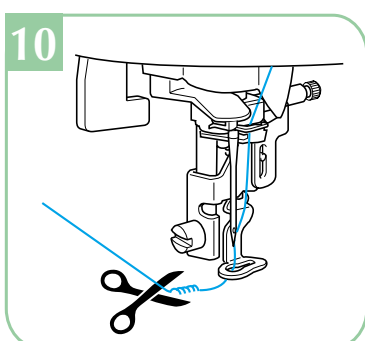
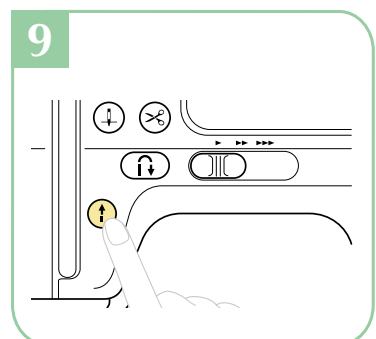
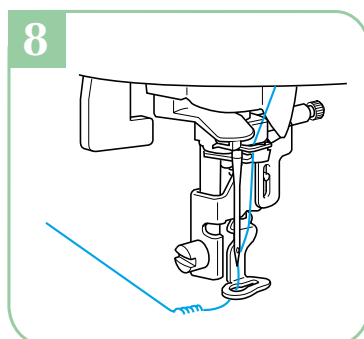
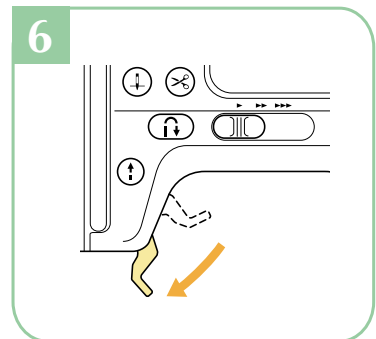
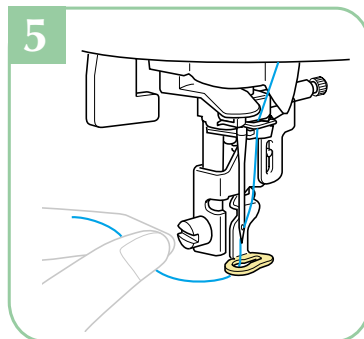
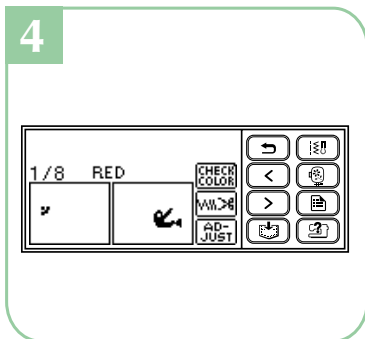
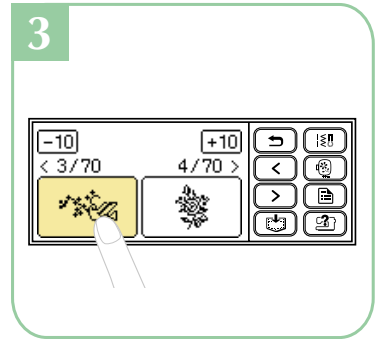
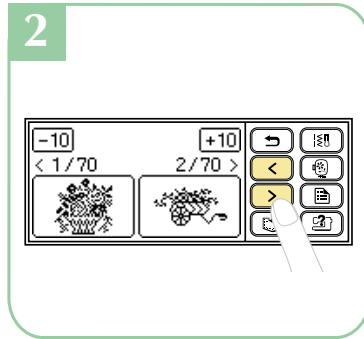
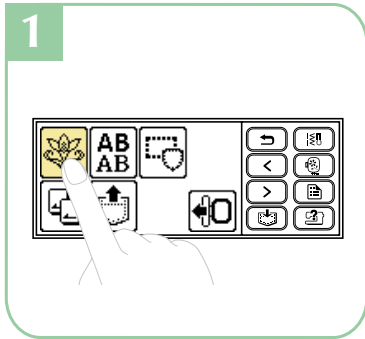

## LCD Flow Chart Diagrama de flujo del LCD

- ◆ Embroidery Patterns
- ◆ Patrones de bordado

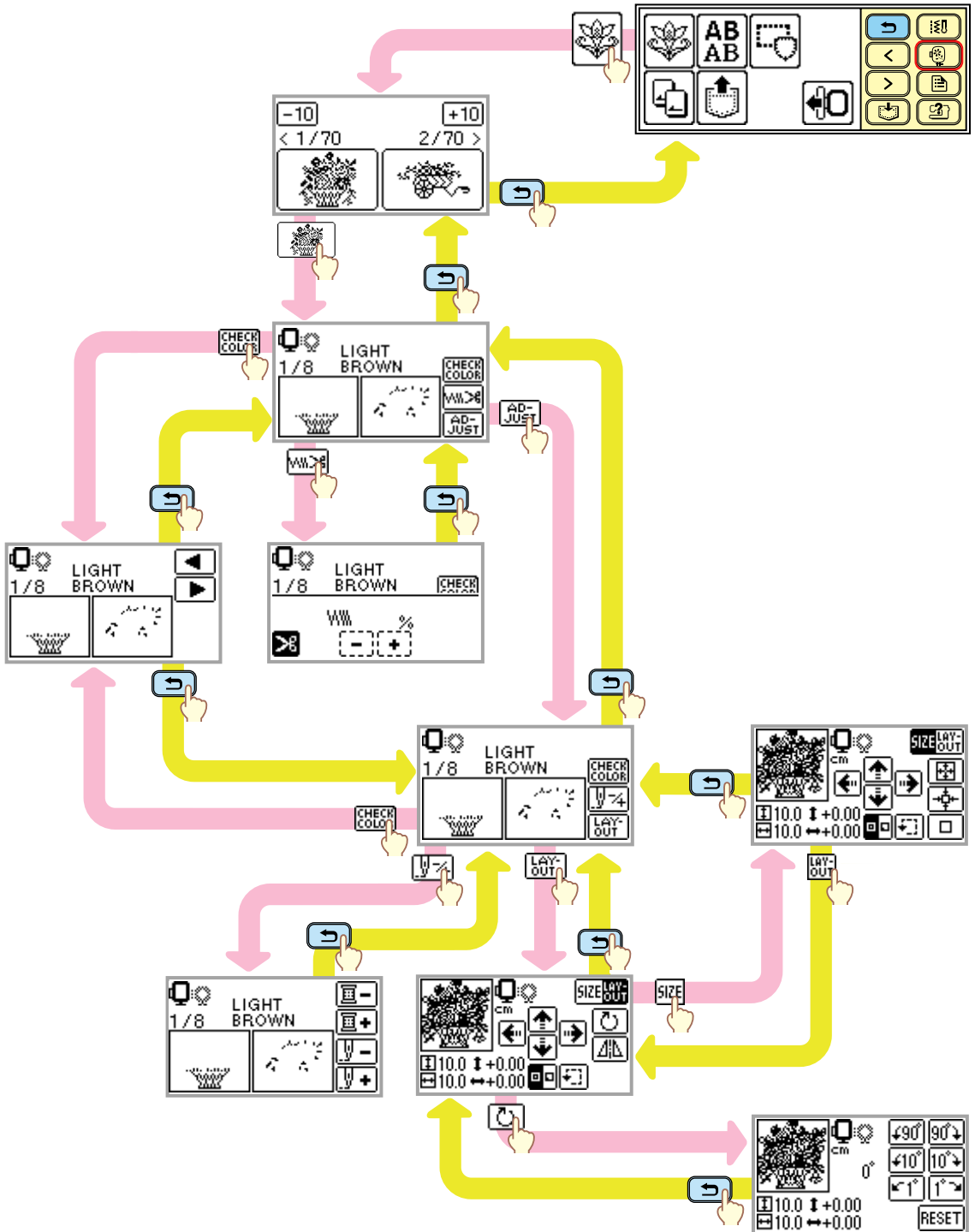

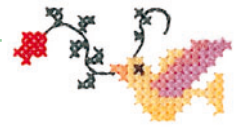

# LCD Flow Chart

## Diagrama de flujo del LCD

- ◆ Other Patterns
- ◆ Otros patrones

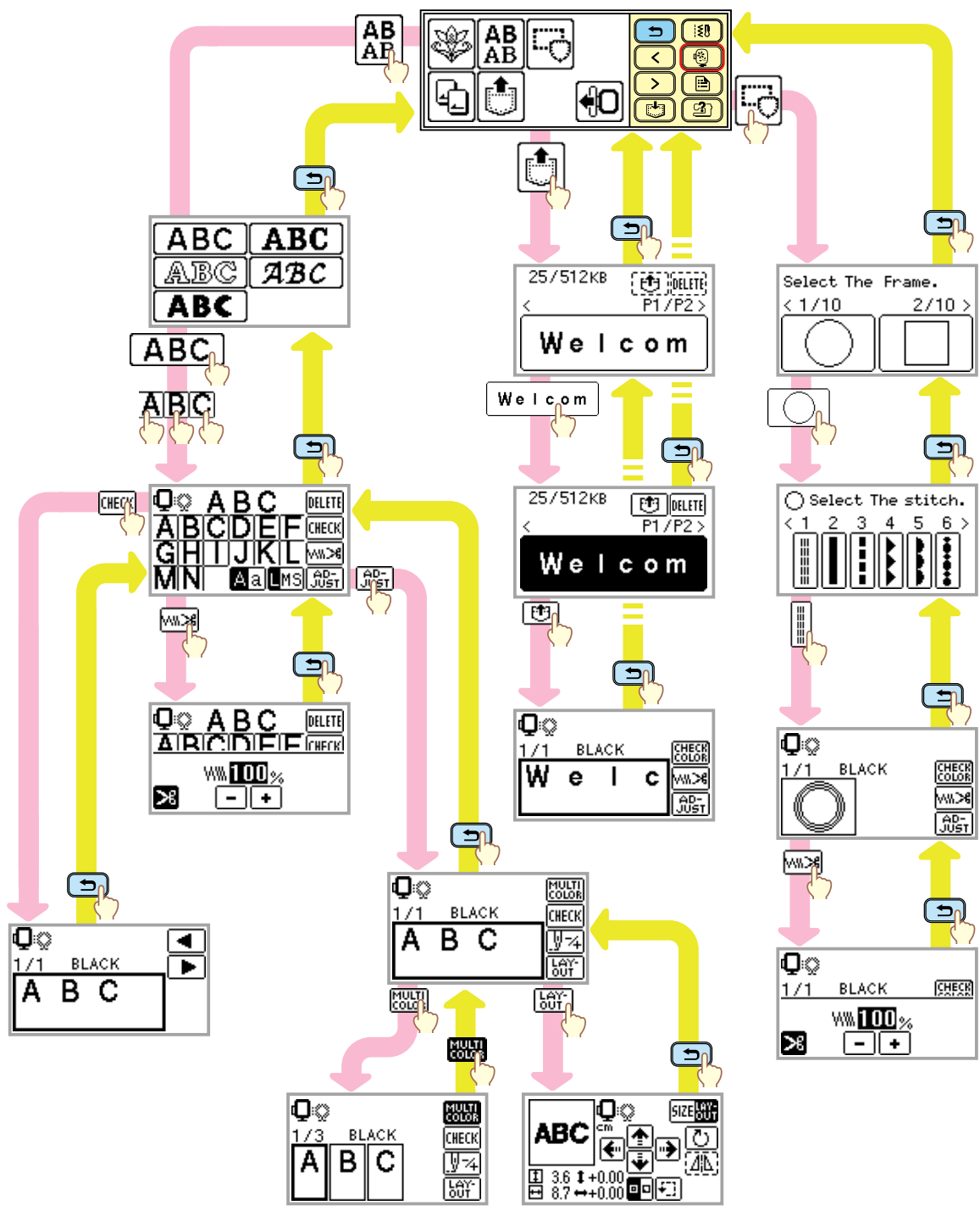

# Alphanumeric Character Patterns

## Patrón de caracteres alfanumérico



AB  
AB

ABC

A B C D E F G H I J K L M N O P Q R S  
T U V W X Y Z  
a b c d e f g h i j k l m n o p q r s  
t u v w x y z  
0 1 2 3 4 5 6 7 8 9  
& ? ! - \_ ( ) ' . , /  
Ä Å Æ Æ Ñ Ö Ø Ç Ü  
ä à â â æ ë è é ê ñ ö ò ø ì ç ü ù ß

ABC

A B C D E F G H I J K L M N O P Q R S  
T U V W X Y Z  
a b c d e f g h i j k l m n o p q r s  
t u v w x y z  
0 1 2 3 4 5 6 7 8 9  
& ? ! - \_ ( ) ' . , /  
Ä Å Æ Æ Ñ ö Ø ç ü  
ä à â â æ ë è é ê ñ ö ò ø ì ç ü ù ß

ABC

A B C D E F G H I J K L M N O P Q R S  
T U V W X Y Z  
a b c d e f g h i j k l m n o p q r s  
t u v w x y z  
0 1 2 3 4 5 6 7 8 9  
& ? ! - \_ ( ) ' . , /  
Ä Å Æ Æ Ñ ö Ø Ç Ü  
ä à â â æ ë è é ê ñ ö ò ø ì ç ü ù ß



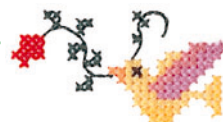

**ABC**

A B C D E F G H I J K L M N O P Q R S  
T U V W X Y Z  
a b c d e f g h i j k l m n o p q r s  
t u v w x y z  
0 1 2 3 4 5 6 7 8 9  
& ? ! - \_ ( ) ' . , /  
Ä Å Ä Æ Ñ Ö Ø Ç Ü  
ä å ä â œ ë è é ê ñ ö ò ø ï ç ü ù ß

**ABC**

A B C D E F G H I J K L M N O P Q R S  
T U V W X Y Z  
a b c d e f g h i j k l m n o p q r s  
t u v w x y z  
0 1 2 3 4 5 6 7 8 9  
& ? ! - \_ ( ) ' . , /  
Ä Å Ä Æ Ñ Ö Ø Ç Ü  
ä å ä â œ ë è é ê ñ ö ò ø ï ç ü ù ß



# Frame Patterns

## Costuras de encuadre



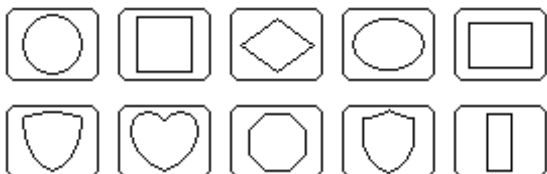

- Frame shapes
- Tipos de bastidores





- Stitches
- Puntadas

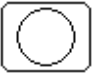

- Sample at actual size
- Muestra en tamaño real

Sample combining  and 

Muestra combinando  y 

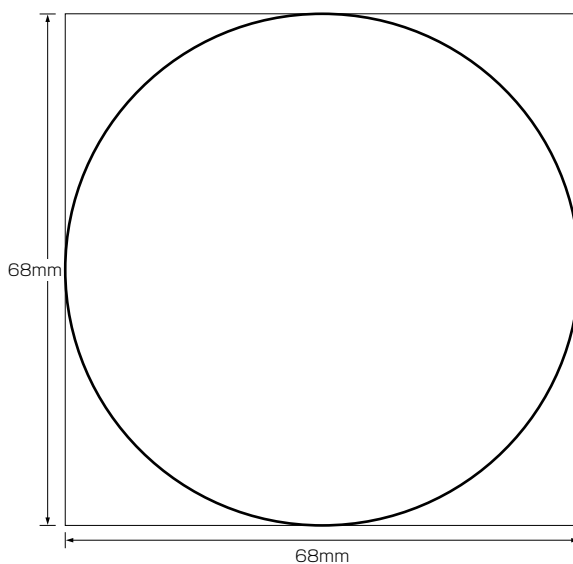

# Embroidery Pattern Color Change Table

## Tabla de cambio de color para patrones de bordado



**No.1** 25min

Order to embroider / Orden para el bordador

- 1 (255)
- 2 (463)
- 3 (444)
- 4 (155)
- 5 (024)
- 6 (224)
- 7 (334)
- 8 (485)

Size  
 $\updownarrow$  10.0cm  $\leftrightarrow$  10.0cm

Embroidery thread color number / Número de color del hilo de bordado

COUNTRY

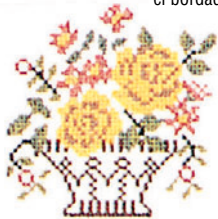

Time required for embroidering / Tiempo requerido para el bordado



**No.5** 21min

- 1 (126)
- 2 (155)
- 3 (152)
- 4 (122)
- 5 (625)
- 6 (624)
- 7 (623)
- 8 (476)
- 9 (485)
- 10 (463)
- 11 (461)
- 12 (446)
- 13 (444)
- 14 (354)
- 15 (404)
- 16 (370)
- 17 (126)
- 18 (636)
- 19 (224)
- 20 (476)

Size  
 $\updownarrow$  9.4cm  $\leftrightarrow$  7.6cm

COUNTRY

**No.9** 3min

- 1 (019)
- 2 (017)
- 3 (070)

Size  
 $\updownarrow$  1.6cm  $\leftrightarrow$  9.0cm

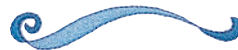

**No.10** 6min

- 1 (001)
- 2 (810)
- 3 (017)
- 4 (019)
- 5 (070)

Size  
 $\updownarrow$  4.1cm  $\leftrightarrow$  6.3cm



**No.2** 10min

- 1 (334)
- 2 (322)
- 3 (335)
- 4 (336)
- 5 (473)
- 6 (354)
- 7 (485)
- 8 (148)
- 9 (255)

Size  
 $\updownarrow$  4.8cm  $\leftrightarrow$  9.4cm

COUNTRY

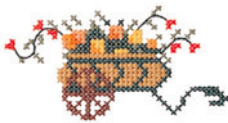

**No.6** 6min

- 1 (588)
- 2 (000)
- 3 (126)
- 4 (024)
- 5 (255)
- 6 (354)
- 7 (586)

Size  
 $\updownarrow$  3.4cm  $\leftrightarrow$  8.1cm

COUNTRY



**No.11** 21min

- 1 (513)
- 2 (534)
- 3 (612)
- 4 (620)
- 5 (070)
- 6 (010)

Size  
 $\updownarrow$  9.6cm  $\leftrightarrow$  8.6cm



**No.3** 3min

- 1 (149)
- 2 (370)
- 3 (334)
- 4 (133)
- 5 (624)
- 6 (322)
- 7 (717)
- 8 (485)

Size  
 $\updownarrow$  2.8cm  $\leftrightarrow$  5.4cm

COUNTRY

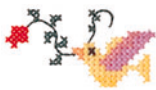

**No.7** 5min

- 1 (476)
- 2 (126)
- 3 (024)
- 4 (122)

Size  
 $\updownarrow$  8.1cm  $\leftrightarrow$  1.6cm

COUNTRY



**No.12** 17min

- 1 (502)
- 2 (612)
- 3 (070)
- 4 (010)
- 5 (007)

Size  
 $\updownarrow$  7.4cm  $\leftrightarrow$  7.4cm



**No.4** 5min

- 1 (024)
- 2 (152)
- 3 (444)
- 4 (473)
- 5 (623)

Size  
 $\updownarrow$  5.3cm  $\leftrightarrow$  4.0cm

COUNTRY



**No.8** 23min

- 1 (017)
- 2 (019)
- 3 (070)
- 4 (810)
- 5 (001)
- 6 (019)
- 7 (070)

Size  
 $\updownarrow$  9.4cm  $\leftrightarrow$  9.4cm



**No.13** 9min

- 1 (502)
- 2 (010)
- 3 (208)

Size  
 $\updownarrow$  7.3cm  $\leftrightarrow$  6.0cm



No.14



**20min**

- 1 (502)
- 2 (010)
- 3 (208)
- 4 (810)
- 5 (086)
- 6 (017)
- 7 (085)
- 8 (328)

Size  
 ↓9.6cm ↔6.7cm

No.19



**9min**

- 1 (017)

Size  
 ↓5.9cm ↔8.3cm

No.24



**1min**

- 1 (612)

Size  
 ↓5.8cm ↔9.4cm

No.15



**4min**

- 1 (534)
- 2 (800)
- 3 (307)
- 4 (030)

Size  
 ↓2.7cm ↔4.1cm

No.20



**8min**

- 1 (126)

Size  
 ↓9.2cm ↔8.5cm

COUNTRY (C)

No.25



**3min**

- 1 (019)
- 2 (807)

Size  
 ↓4.9cm ↔6.2cm

No.16



**10min**

- 1 (534)
- 2 (800)
- 3 (070)
- 4 (307)
- 5 (019)
- 6 (030)

Size  
 ↓8.9cm ↔9.0cm

No.21



**6min**

- 1 (126)

Size  
 ↓7.8cm ↔9.3cm

COUNTRY (C)

No.26



**5min**

- 1 (017)
- 2 (205)
- 3 (513)
- 4 (086)
- 5 (001)
- 6 (017)

Size  
 ↓3.2cm ↔3.4cm

No.27



**4min**

- 1 (807)
- 2 (515)
- 3 (001)
- 4 (070)

Size  
 ↓3.0cm ↔7.9cm

No.17



**6min**

- 1 (070)
- 2 (079)

Size  
 ↓6.9cm ↔6.3cm

No.22

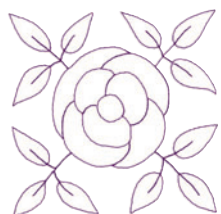

**2min**

- 1 (612)

Size  
 ↓9.6cm ↔9.4cm

No.28



**10min**

- 1 (208)
- 2 (205)
- 3 (900)
- 4 (620)
- 5 (001)
- 6 (515)

Size  
 ↓5.0cm ↔4.1cm

No.18



**2min**

- 1 (124)

Size  
 ↓2.7cm ↔3.0cm

No.23



**1min**

- 1 (612)

Size  
 ↓4.7cm ↔8.5cm

No.29



**4min**

- 1 (337)
- 2 (030)
- 3 (058)

Size  
 ↓2.5cm ↔2.5cm

## Embroidery Pattern Color Change Table Tabla de cambio de color para patrones de bordado

**No.30**



11min	
1	(800)
2	(007)
3	(307)
4	(399)
5	(900)
6	(017)
7	(001)
8	(800)

Size  
↕ 5.6cm ↔ 9.0cm

**No.31**



5min	
1	(800)
2	(515)
3	(017)
4	(124)
5	(206)

Size  
↕ 3.7cm ↔ 3.6cm

**No.32**



9min	
1	(586)
2	(025)
3	(473)
4	(242)
5	(224)
6	(255)
7	(747)

Size  
↕ 5.0cm ↔ 5.0cm

COUNTRY

**No.33**



20min	
1	(513)
2	(001)
3	(323)
4	(800)
5	(017)
6	(810)
7	(900)
8	(513)
9	(001)
10	(323)
11	(019)
12	(070)
13	(900)
14	(058)
15	(502)
16	(704)
17	(900)

Size  
↕ 9.6cm ↔ 6.5cm

**No.34**



3min	
1	(001)
2	(307)
3	(707)

Size  
↕ 2.6cm ↔ 2.4cm

**No.35**



5min	
1	(001)
2	(323)
3	(010)
4	(900)

Size  
↕ 3.4cm ↔ 3.8cm

**No.36**



5min	
1	(001)
2	(843)
3	(707)
4	(900)

Size  
↕ 4.0cm ↔ 2.7cm

**No.37**



3min	
1	(001)
2	(405)
3	(017)
4	(800)

Size  
↕ 3.2cm ↔ 3.3cm

**No.38**



1min	
1	(800)
2	(017)
3	(339)

Size  
↕ 1.6cm ↔ 2.5cm

**No.39**



3min	
1	(704)

Size  
↕ 2.3cm ↔ 3.0cm

★ **No.40**



3min	
1	(107)
2	(107)
3	(107)
4	(328)

Size  
↕ 4.9cm ↔ 4.8cm

**No.41**



5min	
1	(800)
2	(205)
3	(001)
4	(507)
5	(900)

Size  
↕ 2.4cm ↔ 5.7cm

**No.42**



2min	
1	(205)
2	(405)
3	(507)
4	(800)
5	(900)

Size  
↕ 2.4cm ↔ 5.8cm

★ **No.43**



7min	
1	(019)
2	(019)
3	(019)
4	(205)
5	(507)
6	(007)
7	(900)

Size  
↕ 5.6cm ↔ 5.7cm

★ **No.44**



17min	
1	(800)
2	(800)
3	(800)
4	(019)
5	(800)
6	(513)
7	(124)
8	(085)
9	(086)



Size  
↕ 6.2cm ↔ 6.2cm

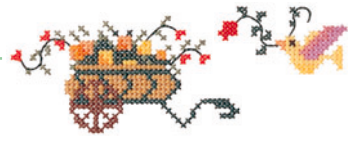

★ Refer to the operation manual for the sewing machine for details on how to embroider appliqués.

★ Consulte el manual de instrucciones de la máquina de coser para los detalles sobre cómo bordar los apliques.





No.45    
 1  (070)  
 Size  
 ⇅ 3.1cm ⇅ 3.9cm



No.54    
 1  (070)  
 Size  
 ⇅ 4.5cm ⇅ 3.1cm



No.63    
 1  (070)  
 Size  
 ⇅ 3.1cm ⇅ 2.9cm

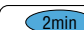

No.46    
 1  (070)  
 Size  
 ⇅ 3.1cm ⇅ 3.6cm

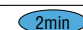

No.55    
 1  (070)  
 Size  
 ⇅ 3.1cm ⇅ 4.0cm

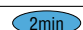

No.64    
 1  (070)  
 Size  
 ⇅ 3.4cm ⇅ 3.4cm

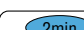

No.47    
 1  (070)  
 Size  
 ⇅ 3.1cm ⇅ 2.9cm

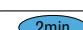

No.56    
 1  (070)  
 Size  
 ⇅ 3.1cm ⇅ 3.1cm

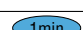

No.65    
 1  (070)  
 Size  
 ⇅ 3.1cm ⇅ 3.7cm



No.48    
 1  (070)  
 Size  
 ⇅ 3.1cm ⇅ 3.1cm



No.57    
 1  (070)  
 Size  
 ⇅ 3.1cm ⇅ 4.6cm

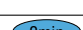

No.66    
 1  (070)  
 Size  
 ⇅ 3.1cm ⇅ 3.5cm

No.49    
 1  (070)  
 Size  
 ⇅ 3.1cm ⇅ 2.8cm



No.58    
 1  (070)  
 Size  
 ⇅ 3.1cm ⇅ 4.3cm



No.67    
 1  (070)  
 Size  
 ⇅ 3.1cm ⇅ 5.3cm

No.50    
 1  (070)  
 Size  
 ⇅ 3.5cm ⇅ 3.2cm



No.59    
 1  (070)  
 Size  
 ⇅ 3.1cm ⇅ 2.6cm



No.68    
 1  (070)  
 Size  
 ⇅ 3.1cm ⇅ 3.8cm

No.51    
 1  (070)  
 Size  
 ⇅ 3.1cm ⇅ 2.4cm

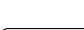

No.60    
 1  (070)  
 Size  
 ⇅ 3.1cm ⇅ 3.2cm



No.69    
 1  (070)  
 Size  
 ⇅ 3.1cm ⇅ 2.9cm

No.52    
 1  (070)  
 Size  
 ⇅ 3.2cm ⇅ 4.2cm

No.61    
 1  (070)  
 Size  
 ⇅ 3.1cm ⇅ 2.6cm

No.70    
 1  (070)  
 Size  
 ⇅ 4.5cm ⇅ 3.3cm

No.53    
 1  (070)  
 Size  
 ⇅ 3.1cm ⇅ 2.7cm

No.62    
 1  (070)  
 Size  
 ⇅ 3.1cm ⇅ 3.7cm











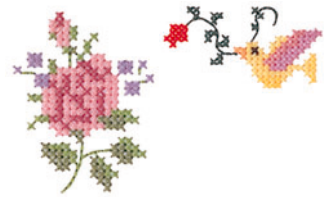



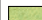

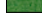
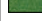







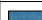







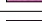
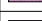



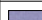

# Color Thread Conversion Chart

## Tabla de conversión de hilos de color

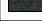
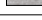

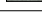
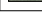
	Color Name	Embroidery	Country	Madeira Polyneon	Madeira Rayon	Sulky Rayon	R.A. Polyester
1	Black / Negro	900	100	1800	1000	1005	5596
2	White / Blanco	001	000	1801	1002	1001	5597
3	Red / Rojo	800	149	1637	1037	1037	5678
4	Pink / Rosado	085	155	1921	1108	1224	5523
5	Deep Rose / Rosa Intenso	086	024	1721	1117	1154	9168
6	Flesh Pink / Rosa Claro	124	152	1915	1015	1064	5677
7	Dark Fuchsia / Fucsia Oscuro	107	126	1984	1383	1533	5804
8	Vermilion / Bermellon	030	148	1779	1179	1184	9023
9	Carmin / Carmin	807	158	1986	1081	1511	5561
10	Royal Purple / Violeta Real	869	636	1788	1188	1192	5681
11	Magenta / Magenta	620	625	1710	1319	1191	5592
12	Salmon Pink / Rosa Salmon	079	122	1816	1317	1225	5773
13	Amber Red / Rojo Ambar	333	212	1942	1341	1119	5591
14	Lemon Yellow / Amarillo Limon	202	342	1623	1023	1067	5625
15	Yellow / Amarillo	205	043	1980	1068	1187	5860
16	Harvest Gold / Amarillo Trigo	206	334	1971	1024	1124	5770
17	Orange / Naranja	208	335	1951	1137	1024	5694
18	Pumpkin / Calabaza	126	322	1952	1155	1065	5630
19	Tangerine / Tangerina	209	336	1965	1078	1078	5518
20	Cream Brown / Marron Crema	010	331	1866	1022	1061	5761
21	Cream Yellow / Amarillo Crema	812	370	1861	1349	1135	5564
22	Khaki / Caqui	348	242	1939	1255	1055	5636
23	Deep Gold / Amarillo Oro	214	354	1772	1172	1025	5770
24	Brass / Bronce	328	404	1791	1192	1159	9109
25	Linen / Lino	307	025	1682	1149	1082	5635
26	Dark Brown / Marron Oscuro	058	717	1859	1130	1129	5637
27	Reddish Brown / Marron Rojizo	337	264	1753	1253	1021	5781
28	Clay Brown / Marron Tierra	339	224	1621	1021	1158	5590
29	Beige / Beige	843	012	1738	1138	1127	5598
30	Warm Gray / Gris Caliente	399	706	1860	1085	1218	9126
31	Russet Brown / Marron Bermejo	330	414	1726	1194	1126	5702
32	Light Brown / Marron Claro	323	255	1729	1056	1128	5789
33	Seacrest / Verde Celadon	542	505	1647	1219	1077	5578
34	Mint Green / Verde Menta	502	461	1702	1302	1047	5511
35	Leaf Green / Verde De Hoja	509	463	1749	1050	1510	5514
36	Olive Green / Verde Oliva	519	476	1904	1396	1174	5502
37	Dark Olive / Verde Oliva Oscuro	517	473	1769	1156	1156	9122
38	Teal Green / Verde Azulado	534	483	1879	1298	1503	5751
39	Emerald Green / Verde Esmeralda	507	485	1750	1250	1079	5508
40	Deep Green / Verde Intenso	808	467	1703	1370	1208	5615



	Color Name	Embroidery	Country	Madeira Polyneon	Madeira Rayon	Sulky Rayon	R.A. Polyester
41	Fresh Green / Verde Fresco	 027	 442	1706	1102	1209	9153
42	Lime Green / Verde Lima	 513	 444	1848	1049	1177	5622
43	Moss Green / Verde Musgo	 515	 446	1770	1369	1176	9091
44	Blue / Azul	 405	 586	1829	1177	1076	5684
45	Ultra Marine / Azul De Ultramar	 406	 575	1842	1076	1042	5736
46	Light Blue / Azul Claro	 017	 150	1932	1132	1074	5683
47	Sky Blue / Celeste	 019	 512	1828	1029	1196	5506
48	Electric Blue / Azul Electrico	 420	 564	1797	1297	1250	5829
49	Peacock Blue / Azul Pavo Real	 415	 057	1652	1252	1206	5810
50	Prussian Blue / Azul De Prusia	 007	 588	1767	1166	1535	5737
51	Cornflower Blue / Azul Centaura	 070	 015	1830	1335	1028	5601
52	Light Lilac / Lila Suave	 810	 133	1911	1031	1121	9016
53	Lilac / Lila	 612	 623	1831	1080	1080	9009
54	Violet / Violeta	 613	 624	1631	1033	1194	5588
55	Purple / Purpura	 614	 635	1880	1122	1122	5554
56	Lavender / Lavanda	 804	 604	1630	1261	1193	5586
57	Wisteria Violet / Violeta Vistaria	 607	 003	1943	1311	1032	5587
58	Pewter / Peltre	 704	 745	1840	1041	1041	9114
59	Dark Gray / Gris Oscuro	 707	 747	1841	1241	1220	5565
60	Silver / Plata	 005	 020	1812	1087	1011	5640
61	Gray / Gris	 817	 734	1640	1118	1219	5782
62		-----X					
63		-----					
64		~~~~~ TTTTTTTTTTTTTTTTTTTT					
65	NOT DEFINED / SIN DEFINIR						

**Note:** The conversion chart is based on Embroidery thread. The color shades may vary with the different brands listed on the chart. If unsure of a particular color(s), please sew test. Robison Anton, Isacord, Madeira, Sulky and Güetermann are respectively registered trademarks. Actual colors may vary slightly from the chart.

**Nota:** La tabla de conversión está basada en hilo de bordar. Los tonos de color podrán variar con las diferentes marcas listadas en la tabla. Si tiene dudas sobre un color(es) particular, haga un cosido de prueba. "Robison Anton", "Isacord", "Madeira", "Sulky" y "Güetermann" son marcas registradas respectivamente. Los colores verdaderos podrán variar ligeramente con respecto a los de la tabla.

