



## Julie Fei-Fan Balzer

Take your shadow boxes to the next level with the ScanNCut machine from Brother. Check out how I was able to create this fun mixed media shadow box in just a short amount of time!

### MATERIALS:

Brother ScanNCut machine, cardstock, foam, ruler, bone folder, craft knife, scissor, painted or patterned paper

### step 1.

Scan your design into the ScanNCut machine. Anything that is white will be part of your box front. Anything that is black will be cut away. For your box not to fall apart, you'll need many parts of your design to touch the edges.



### step 2.

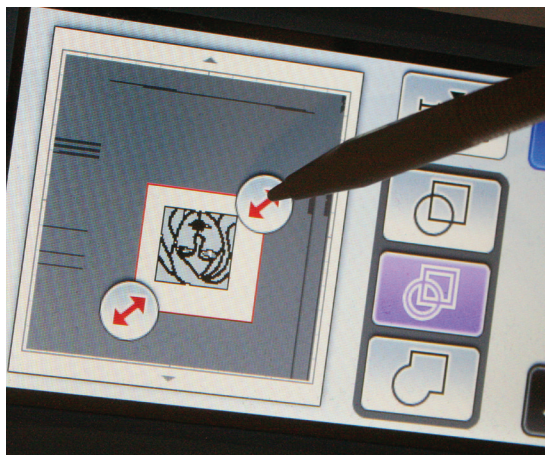

Choose the second scanning option and drag the red arrows close around your image.

### step 3.

For a stronger scan, choose the grayscale button.

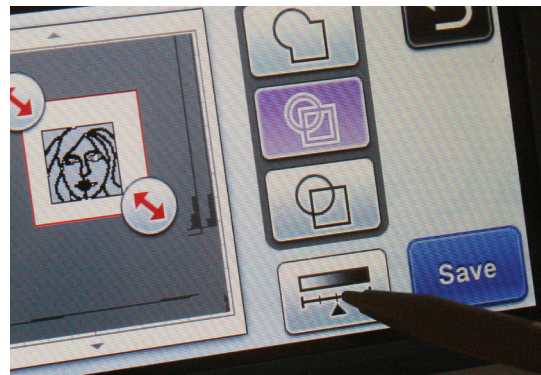

### step 4.

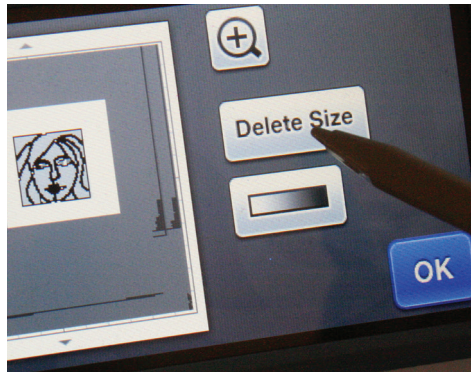

Choose delete size.

### step 5.

Using the minus button, reduce the margin size to the lowest possible number. Hit okay.

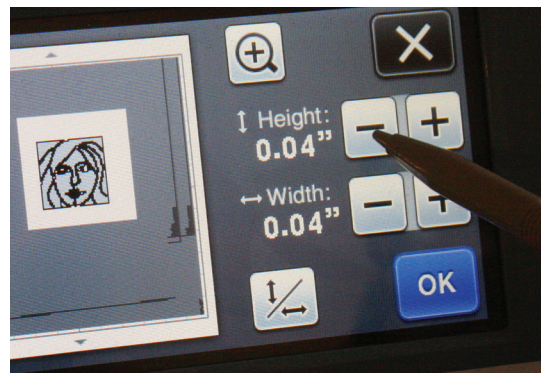

### step 6.



Save your file



### step 7.

Once you're ready to cut (i.e. you've loaded paper onto the cutting mat and into the machine, and chosen the image you want to cut), choose the scanning option.

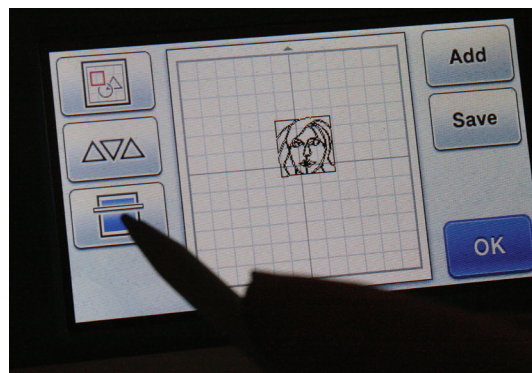

### step 8.

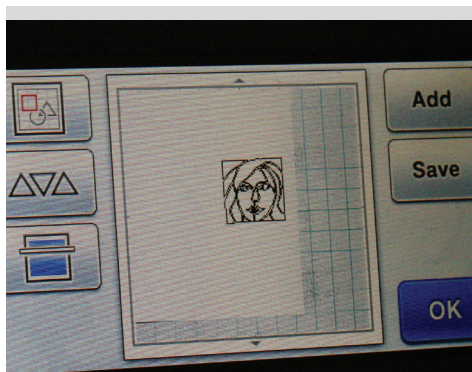

You'll see that your image doesn't necessarily line up with your paper.

### step 9.

Select All and drag the image into the center of your paper. You're ready to cut!

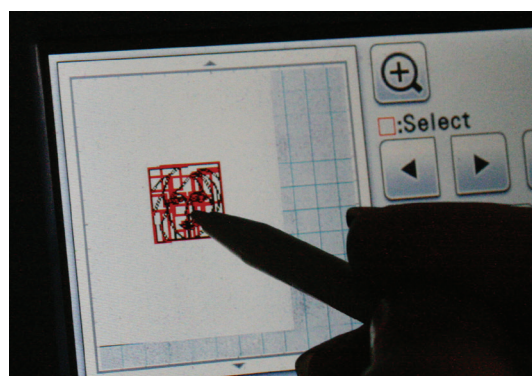

### step 10.

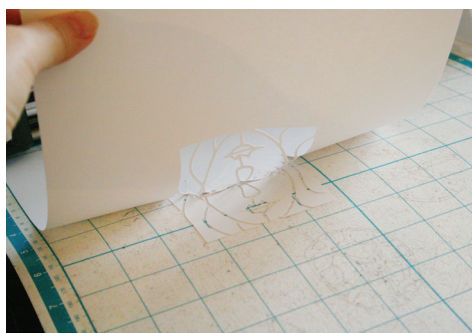

After the image has been cut, carefully peel it up from the mat. Take your time.

### step 11.



Remove your cut image and turn off the machine. We're ready to put our box together

### step 12.

Using a piece of foam, a ruler, and a bone folder, score about 1/4" away from the box outline.

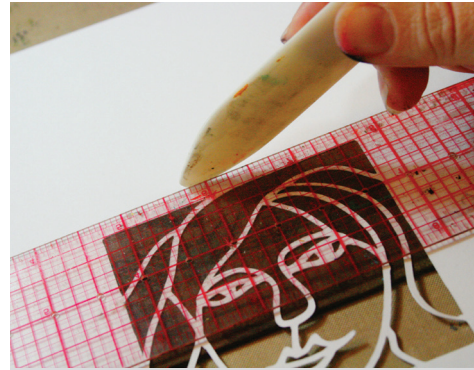

### step 13.



Be sure to score all four sides.

### step 14.

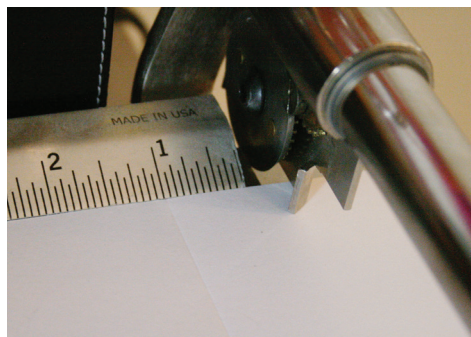

Trim the paper 1" away from the score line on all four sides



### step 15.

You should have a square with your design in the center and score lines all around.



### step 16.



On opposing sides, cut small slits along the score lines to where the score lines cross. Four cuts in total, as seen in the photo.

### step 17.

Fold and crease along all of the score lines.



### step 18.



Apply adhesive to each of the four tabs. Adhere the box top together.

### step 19.



Cut a piece of painted paper into a square, slightly smaller than your box top. This is the box bottom and so it needs to fit inside the box top.

### step 20.

Score the box bottom 1" from the edge on all four sides, snip (as above), fold & crease along the score lines, place adhesive on the tabs, and put your box bottom together.



### step 21.

Place the box top on the box bottom and you're done!



*This project was created from the designer's perspective.*