

- (4) On the Control Panel, press the Platen Button to eject the Platen if it is not.

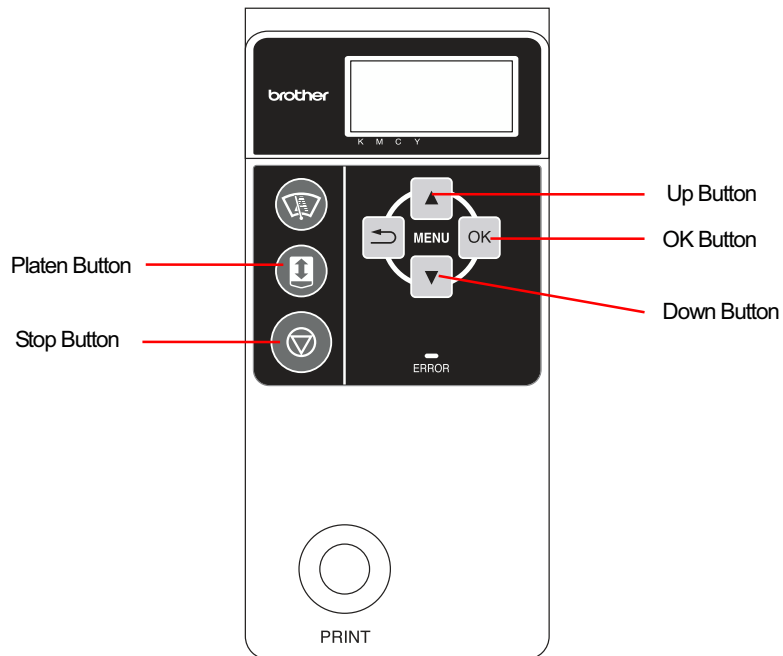

- (5) Press the OK Button to display the Menu Display.
(6) Press the Up/Down Button until "Version" appears.
(7) While holding down both the Up and Down Buttons, press the Stop Button.



- (8) Press the Up/Down Button to select "Tube Cleaning", and then press the OK Button.

